

AN EVENTS & FILM LOCATION  
IN THE HEART OF EAST LONDON!



# MUDCHUTE Park & Farm



# EAST

## Mudchute Park & Farm the perfect location for your event!

Two fantastic event spaces  
with unrivaled city views.

Transport links – **5 mins away.**

**32 acres** of countryside in the  
heart of East London.



# LONDON

# ADDRESS

Mudchute Park & Farm, Pier Street,  
Isle of Dogs, London, E14 3HP

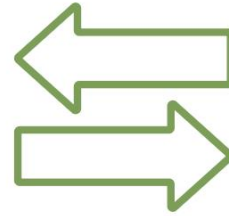

# TRAVEL

## TRANSPORT LINKS

### Road:

Pier Street off Manchester Road (A1206)

### Nearest Station:

Mudshute DLR



### Buses:

135, 277, D7, N550



### Parking:

Larger events can hire the Lower Paddock at an additional fee for parking, whilst their event is held in the Upper Paddocks



# LICENCING

**Please note** that this is the responsibility of the visiting party to check with Tower Hamlets Council if additional event licencing is required. You may need to secure either of the following licences in addition to the site licence that The Film Office Ltd issue you:

Mudchute Park & Farm / The Film Office Ltd can take no responsibility for the visiting party's failure to secure any additional licencing as required by government and Tower Hamlets Council.

## TEMPORARY EVENT NOTICE

- **Notice period:** 10 working days
- Event must involve **less than 499 attendees** (including the staff)

## PREMISES LICENCE

- Can take **3-4 months** to obtain
- Required when there is a **sale by retail of alcohol/food**
- Attendees over **500**

# HIRE OPTIONS

## Perfect for

- Corporate Festivals
- Brand Activations
- Team Day Out with Fairground Rides

## UPPER PADDOCK

A large field with unrivaled views of Canary Wharf, this event space has an abundance of rustic and rural features.

## HIRE DETAILS

**Capacity:** 3,000 maximum

**Perimeter:** Approx 385m

**Area:** Approx 7,805 m2

**Hours Available:** 09:00-22:00  
(extensions may be considered)

**Attendees Event Day Fee:** £2.50 x  
number of attendees

### Field Hire Fee Per Day:

Small Event (<49 attendees) £1,200+VAT  
Medium Event (50-199 attendees) £1,400+VAT  
Large Event (200-399 attendees) £1,950+VAT  
Very Large Event (+400 attendees) £2,200+VAT

**Booking Fee:** £300 + VAT

## FEES

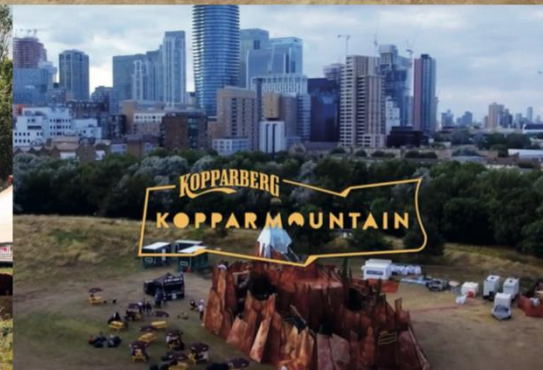
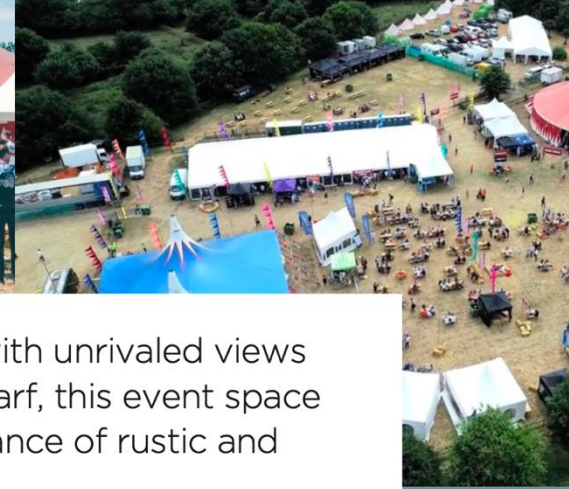

# LOWER PADDOCK

The Lower Paddock at Mudchute is an intimate field ringed with trees, this event space is a private oasis within the busy city.

## Perfect for

- Sports Days
- Family Fun Days
- Team Building Activities
- Picnics

## HIRE DETAILS

**Capacity:** 1,000 maximum

**Perimeter:** Approx 280m

**Area:** Approx 4,195 m2

**Hours Available:** 09:00-20:00  
(extensions may be considered)

**Attendees Event Day Fee:** £2.50 x  
number of attendees

### Field Hire Fee Per Day:

Small Event (<49 attendees) £1,000+VAT  
Medium Event (50-199 attendees) £1,200+VAT  
Large Event (200-399 attendees) £1,700+VAT  
Very Large Event (+400 attendees) £1,950+VAT

**Booking Fee:** £300 + VAT

## FEES





# BARN

## Indoor Spaces Available

170 sqm (1800 sqft)

Situated between the Upper and Lower Paddock, our barn comfortably accommodates up to **40 guests (20 children, plus 20 adults)**

- Kitchenette
- Seating and tables available
- Toilets

**Hire Charges:** dependent on requirements

# HOW TO BOOK YOUR EVENT AT MUDCHUTE PARK & FARM?

1. Email [privates@filmoffice.co.uk](mailto:privates@filmoffice.co.uk) with your enquiry, you will then be provided with an application form. This will be reviewed and pending availability a quote will be provided.
2. To secure your event please go to [www.filmhub.co.uk](http://www.filmhub.co.uk) and click the 'Apply for a Permit' button, from here you will be prompted to fill out some details about the event.
3. Once this has been submitted your payment plan will be implemented.

## PRIOR TO EVENT WE WILL REQUIRE ALL THE PAPERWORK BELOW:

### **Risk Assessment and Public Liability**

For the Event Organisers

### **Risk Assessment and Public Liability**

For any organisations on site  
(catering, infrastructure,  
toilet providers, event companies)

### **Event Management Plan**

A draft copy can be provided if required

### **Resident Letter with proof of letter drop**

Depending on size and impact of event

### **Bank Details for return of deposit**

(Account Name, Account Number,  
Sort Code, Accounts email)



# SUPPLIERS



## Security or Stewarding

We can supply contacts with security and stewarding providers. This is required if equipment is left over night.



## Portable Toilets

**MUST** be hired for all events.

We can supply contacts with a Portable Toilet company.

**Event Management Plans** must include drop and pick up details of this.



## Straw Bales

We are able to provide straw bales for seating, please notify us a minimum of 4 weeks ahead of event so that we can order these in.

They cost £12 per bale.



## Rubbish

The Park operates a **Leave No Trace Policy**:

- All rubbish is to be removed from site
- You **MUST** use your own rubbish bags
- It is forbidden to use ANY on site bins



**ANIMALS:**  
If you do require  
animals for your  
event please ask



# PARKING



Events are allowed up to **3 vehicles** within the event space to facilitate the event.

The Lower Paddock can be hired out to facilitate event parking.

On street parking can be arranged along East Ferry Road through **The Film Office - towerhamlets@filmoffice.co.uk (0207 247 1244)**

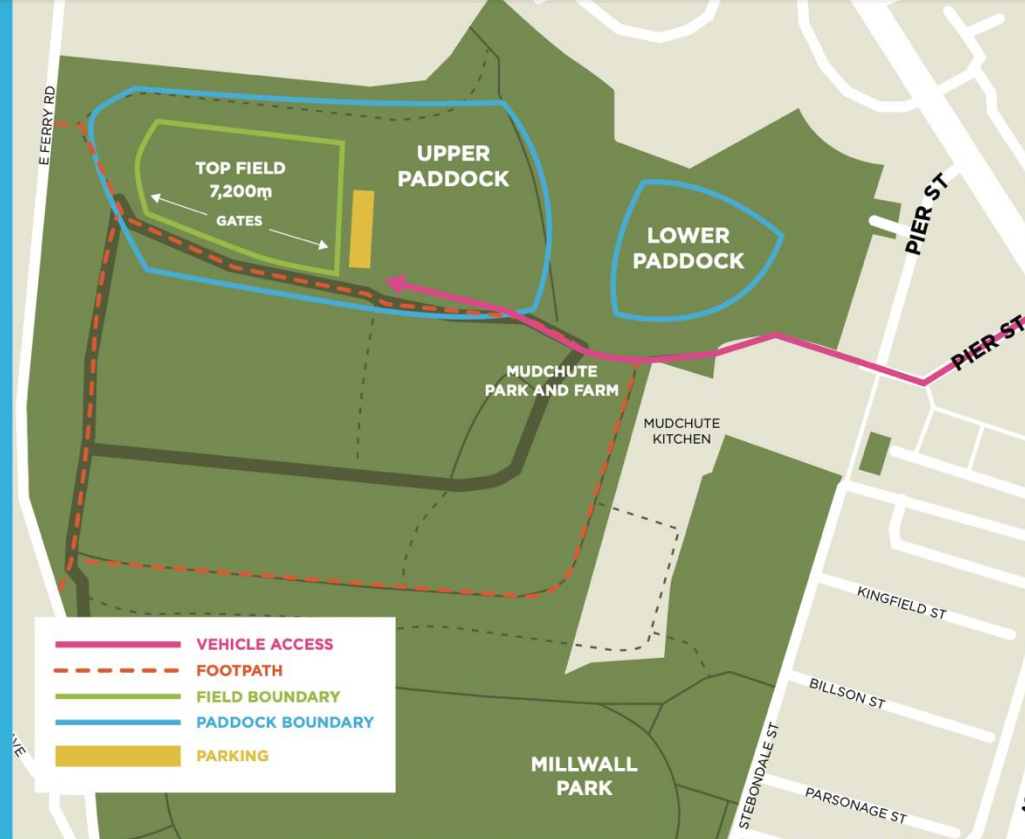

## A selection of our clients include



## Contact Us

0207 247 1244

info@filmooffice.co.uk

www.filmooffice.co.uk



@thefilmoofficeltd



@thefilmooffice



facebook.com/filmooffice



**For all event filming please speak**  
to our recommended provider,  
Itch Media.

**Email:** [hello@itchmedia.com](mailto:hello@itchmedia.com)

**Phone:** 0203 735 9723

**Address:** 7G2 The Leather Market,  
Weston Street, London, SE1 3ER